

IO-Link/Analog Wandler

AI Multi U/I , M12, Single-Wire

IO-Link / analog converter
AI Multi U/I, M12, Single Wire
16Bit, IP65/67, IO-Link V1.1, Class A

Link to Product

Illustration

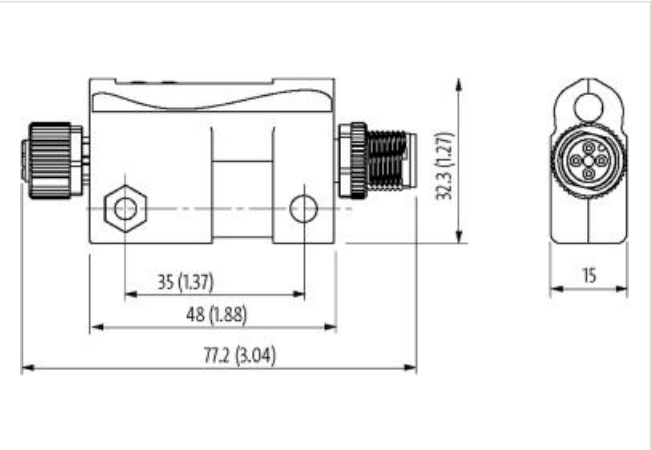
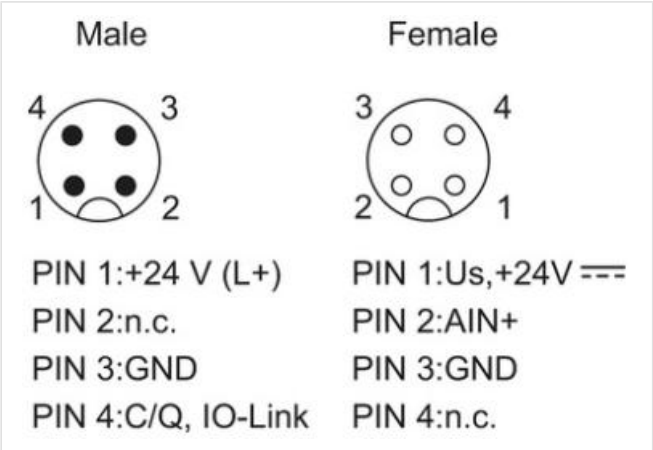

Product may differ from Image



Commercial data	
ECLASS-6.1	27242602
ECLASS-7.0	27242602
ECLASS-8.0	27242602
ECLASS-9.0	27242602
ECLASS-10.1	27242602
ECLASS-11.1	27242602

ECLASS-12.0	27242602
customs tariff number	85437090
GTIN	4048879797269
Packaging unit	1
Electrical data Supply	
Operating voltage DC	24 V
Operating voltage DC min.	18 V
Operating voltage DC max.	30 V
Norm operating voltage	EN 61131-2
Operating voltage US DC	24 V
Current consumption max.	30 mA
Electrical data Input	
Parameterizable input averaging filter process data	yes
Current carrying capacity max.	0,2 A
Conversion time with net suppression	OFF: 10 ms, 50 Hz: 60 ms, 60 Hz: 100 ms
Industrial communication IO-Link	
Port Class	A
IO-Link revision ID	V1.1
IO-Link transmission rate	COM2 (38.4 kbit/s)
IO-Link process data length input	2 Bytes
IO-Link cycle time min.	2,3 ms
Diagnostics	
Diagnostic via IO-Link	yes
Diagnostic via LED	yes
IO-Link events	Device defect, Overtemperature, Overvoltage supply, Undervoltage supply, lower limit, upper limit
Short circuit diagnosis	yes
LED display	Ethernet connection/data traffic
Temperature control	yes
Overload diagnosis	yes
Device protection Electrical	
Degree of protection (EN IEC 60529)	IP65, IP67
Invers-polarity protection	yes
Short circuit protection sensor supply	yes
Resistance to loads with regenerative power	yes
Over voltage protection	yes
Mechanical data Material data	
Material housing	Plastic
Mechanical data Mounting data	
Height	32,3 mm
Width	77,2 mm
Depth	15 mm
Environmental characteristics Climatic	
Operating temperature min.	-30 °C
Operating temperature max.	70 °C
Storage temperature min.	-40 °C
Storage temperature max.	85 °C
Connection type 2	
Family construction form	M12
Gender	female
Coding	A

No. of poles	4
PIN 1	24 V DC (US)
PIN 2	A +
PIN 3	0 V (Analog US)
PIN 4	n.c.
Family construction form	M12
Gender	male
Coding	A
No. of poles	4
PIN 1	24 V DC (L +)
PIN 2	n.c.
PIN 3	0 V (L -)
PIN 4	C / Q / IO-Link