

**M12 female receptacle 90° Y-cod. solder terminal**

M12 Flange female 90°  
 Ethernet CAT5  
 M12, 8-pole  
 Y-coded  
 shielded  
 Solder connection  
 Front mounting

[Link to Product](#)
**Illustration**

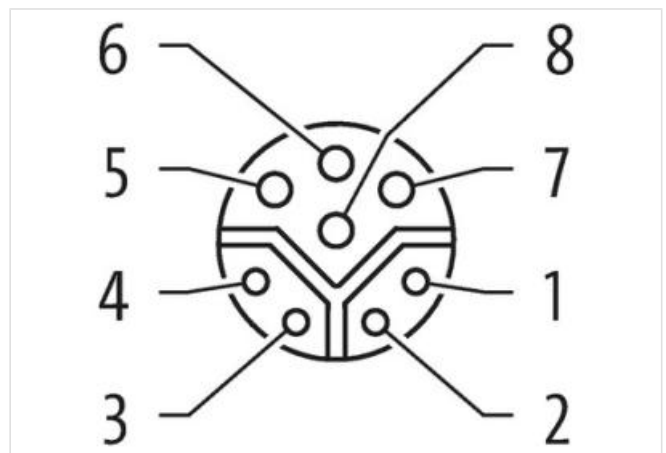
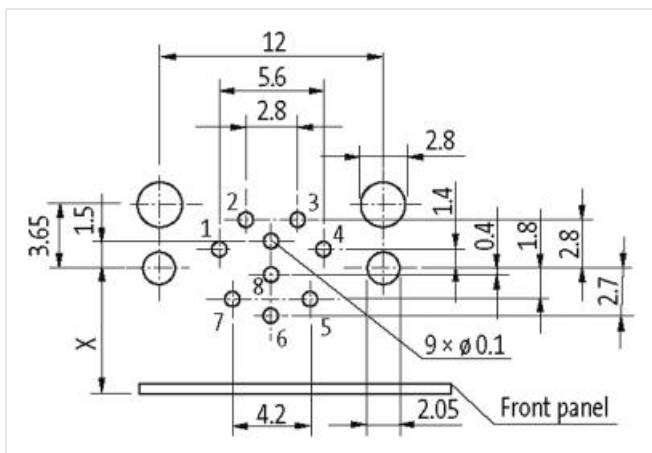
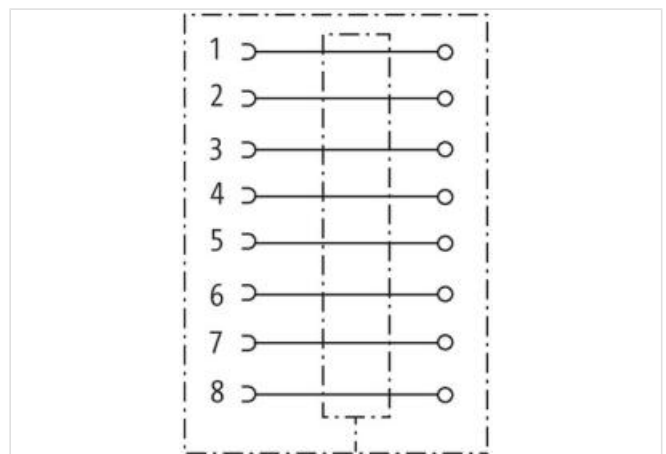
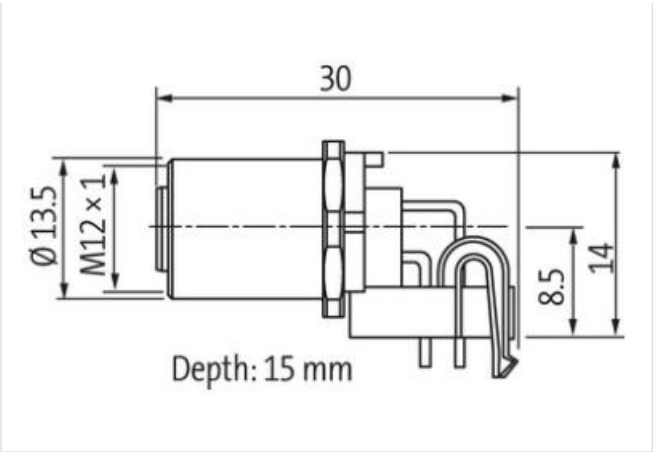

Product may differ from Image

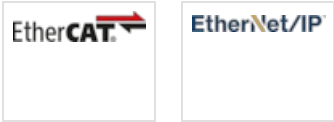

| Side 1  |  |
|---|--|
| Family construction form                          | M12  |
| Coding  | Y  |
| No. of poles                                      | 8  |
| Width across flats                                | SW14   |
| Degree of protection (EN IEC 60529)               | IP67   |
| Commercial data                                   |  |
| ECLASS-6.0  | 27279220   |
| ECLASS-6.1  | 27279220   |
| ECLASS-7.0  | 27440103   |
| ECLASS-8.0  | 27440103   |
| ECLASS-9.0  | 27440109   |
| ECLASS-10.1                                       | 27440109   |
| ECLASS-11.1                                       | 27440109   |
| ECLASS-12.0                                       | 27440109   |
| ETIM-5.0  | EC001855   |
| customs tariff number                             | 85366990   |
| GTIN  | 4048879495431                                    |
| Packaging unit                                    | 1  |
| Electrical data   Supply                          |  |
| Operating voltage AC max.                         | 48 V   |
| Operating voltage DC max.                         | 50 V   |
| Operating current per data contact max.           | 0,5 A  |
| Operating current per power contact max.          | 6 A  |
| Industrial communication                          |  |
| Transfer parameters                               | CAT5, Class D (ISO/IEC 11801:2002), (EN 50173-1) |
| Data transmission rate max.                       | 100 MBit/s                                       |
| Industrial communication   Ethernet functionality |  |
| duplex  | Full duplex                                      |
| Installation   Connection                         |  |
| Tightening torque                                 | 0,6 Nm   |
| Device protection   Electrical                    |  |

|  |                   |
|--|-------------------|
| Additional condition protection degree | inserted, screwed |
| Pollution Degree                       | 3                 |
| Rated surge voltage                    | 0,8 kV            |
| Material group (IEC 60664-1)           | I                 |

**Mechanical data | Material data**

|                  |                  |
|------------------|------------------|
| Coating locking  | Nickel           |
| Locking material | Zinc die-casting |

**Mechanical data | Mounting data**

|                 |                                       |
|-----------------|---------------------------------------|
| Mounting method | inserted, screwed, Shaking protection |
|-----------------|---------------------------------------|

**Environmental characteristics | Climatic**

|                            |        |
|----------------------------|--------|
| Operating temperature min. | -40 °C |
| Operating temperature max. | 85 °C  |

**Important installation notes**

|                        |   |
|------------------------|---|
| Note on strain relief  | Protect the connectors by suitable measures from mechanical loads, e.g. by the usage of cable ties.   |
| Note on bending radius | <b>Attention:</b> Observe the permissible bending radii when laying cables, as the IP protection class can be endangered by excessive bending forces. |