

**M12 female recept. A-cod. front F&B**

PP-wires 4x0.34 0.5m

F&B  
Flange female  
M12, 4-pole  
Front mounting  
with multi-strand wire  
Stainless steel 1.4404 (V4A)

**Link to Product**

**Illustration**

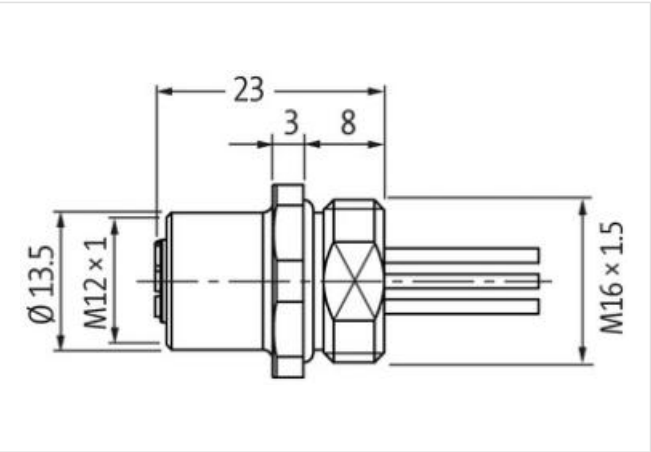

Product may differ from Image



Cable length 0,5 m

**Side 1**

Tightening torque 0,6 Nm

|                                     |              |
|-------------------------------------|--------------|
| Coating contact                     | gold plated  |
| Family construction form            | M12          |
| Thread                              | M12 x 1      |
| Coding                              | A            |
| Material contact                    | Copper alloy |
| No. of poles                        | 4            |
| Degree of protection (EN IEC 60529) | IP67, IP69K  |

**Side 2**

|                 |             |
|-----------------|-------------|
| Coating contact | gold plated |
|-----------------|-------------|

**Commercial data**

|                       |               |
|-----------------------|---------------|
| ECLASS-6.0            | 27279218      |
| ECLASS-6.1            | 27279220      |
| ECLASS-7.0            | 27440103      |
| ECLASS-8.0            | 27440103      |
| ECLASS-9.0            | 27440103      |
| ECLASS-10.1           | 27440103      |
| ECLASS-11.1           | 27440103      |
| ECLASS-12.0           | 27440103      |
| ETIM-5.0              | EC001855      |
| customs tariff number | 85444290      |
| GTIN                  | 4048879363662 |
| Packaging unit        | 1             |

**Electrical data | Supply**

|                                    |       |
|------------------------------------|-------|
| Operating voltage AC max.          | 250 V |
| Operating voltage DC max.          | 250 V |
| Current operating per contact max. | 4 A   |

**Diagnostics**

|                       |    |
|-----------------------|----|
| Status indication LED | no |
|-----------------------|----|

**Installation | Connection**

|                    |           |
|--------------------|-----------|
| Mounting set       | M16 x 1.5 |
| Width across flats | SW19      |

**Device protection | Electrical**

|                              |          |
|------------------------------|----------|
| Protection NEMA              | 3, 4, 6P |
| Pollution Degree             | 3        |
| Rated surge voltage          | 2,5 kV   |
| Material group (IEC 60664-1) | I        |

**Mechanical data**

|                             |         |
|-----------------------------|---------|
| Contour for corrugated hose | without |
|-----------------------------|---------|

**Mechanical data | Material data**

|                  |                              |
|------------------|------------------------------|
| Material gasket  | EPDM                         |
| Material housing | Stainless steel 1.4404 (V4A) |
| Locking material | Stainless steel 1.4404 (V4A) |

**Mechanical data | Mounting data**

|                 |                                       |
|-----------------|---------------------------------------|
| Mounting method | inserted, screwed, Shaking protection |
|-----------------|---------------------------------------|

**Environmental characteristics | Climatic**

|  |                            |
|--|----------------------------|
| Operating temperature min.             | -25 °C                     |
| Operating temperature max.             | 85 °C                      |
| Additional condition temperature range | depending on cable quality |

**Important installation notes**

Note on strain relief      Protect the connectors by suitable measures from mechanical loads, e.g. by the usage of cable ties.

Note on bending radius      **Attention:** Observe the permissible bending radii when laying cables, as the IP protection class can be endangered by excessive bending forces.

#### Conformity

Product standard      DIN EN 61076-2-101 (M12)

#### Approvals

UL 50E      yes

#### Installation | Cable

Cable identification      971

Material wire insulation      PUR

Amount wires      4

Outer diameter insulation      1,3 mm

Outer diameter tolerance core insulation       $\pm 5 \%$

Conductor crosssection (wire)      0,34 mm<sup>2</sup>

Min. operating temperature (static)      -40 °C

Max. operating temperature (fixed)      90 °C

Operating temperature min. (dynamic)      -25 °C

Operating temperature max. (dynamic)      90 °C

Flame resistance      UL 1581 § 1100 FT2 | UL 1581 § 1090 | IEC 60332-2-2

chemical resistance      Good, application-related testing

Gasoline resistance      Good, application-related testing

Oil resistance      DIN EN 60811-404 | Good, application-related testing

Bending radius (fixed)      5 x Outer diameter