

B6 Bulkhead mounted h., IP67

Single locking lever m.

B6  
Bulkhead mounted housing  
Single locking lever  
IP67  
Technical data will be only guaranteed with Murrelektronik components.

Link to Product

Illustration



Product may differ from Image

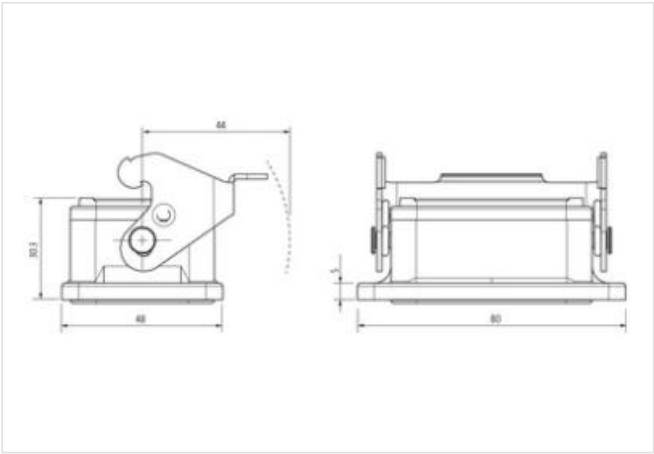

Commercial data

ECLASS-6.0	27143424
ECLASS-6.1	27261203
ECLASS-7.0	27440202
ECLASS-8.0	27440202
ECLASS-9.0	27440202
ECLASS-10.1	27440202
ECLASS-11.1	27440202
ECLASS-12.0	27440202
ETIM-5.0	EC000437
customs tariff number	85389099
GTIN	4048879647205
Packaging unit	1

Installation | Connection

Mating cycles min.	500
--------------------	-----

Device protection | Electrical

Degree of protection (EN IEC 60529)	IP67
Additional condition protection degree	inserted, locked

Mechanical data

Housing type	Bulkhead mounted housing
--------------	--------------------------

Mechanical data | Material data

Coating housing	powder-coated
Coating locking	verzinkt
Material gasket	NBR

Material housing	Aluminum die casting
------------------	----------------------

Locking material	Steel
------------------	-------

**Mechanical data | Mounting data**

Size	B6
------	----

Height	30,3 mm
--------	---------

Width	48 mm
-------	-------

Depth	80 mm
-------	-------

Looking techniques	Single locking lever
--------------------	----------------------

**Environmental characteristics | Climatic**

Operating temperature min.	-40 °C
----------------------------	--------

Operating temperature max.	100 °C
----------------------------	--------

Climatic category (EN IEC 60068-1)	40/100/21
------------------------------------	-----------