

B6 Surface mounted h., high profile, IP65

Single locking lever m.,2 entries M25

B6  
Surface mounted housing (high)  
Single locking lever  
IP65  
Technical data will be only guaranteed with Murrelektronik components.

Link to Product

Illustration

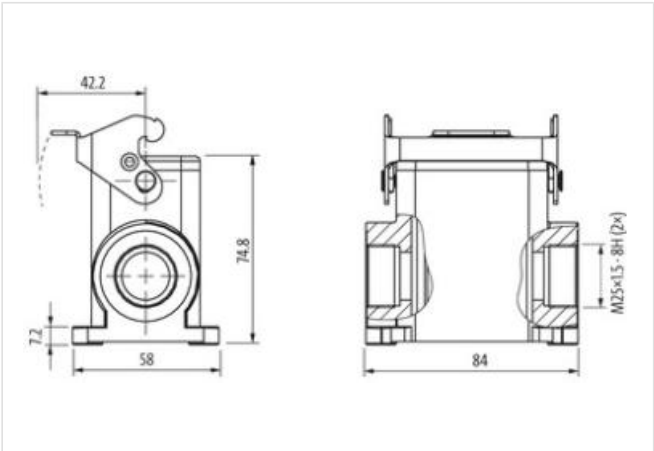

Product may differ from Image

Commercial data	
ECLASS-6.0	27279221
ECLASS-6.1	27261203
ECLASS-7.0	27440202
ECLASS-8.0	27440202
ECLASS-9.0	27440202
ECLASS-10.1	27440202
ECLASS-11.1	27440202
ECLASS-12.0	27440202
ETIM-5.0	EC000437
customs tariff number	85389099
GTIN	4048879696241
Packaging unit	1
Installation	
Cable outlet	double-sided
Installation   Connection	
Mounting set	M25
Mating cycles min.	500
Device protection   Electrical	
Degree of protection (EN IEC 60529)	IP65
Additional condition protection degree	inserted, locked, with screw connection
Mechanical data	
Housing type	Surface mounted housing
Mechanical data   Material data	

Coating housing	powder-coated
Coating locking	verzinkt
Material gasket	NBR
Material housing	Aluminum die casting
Locking material	Steel
<b>Mechanical data   Mounting data</b>	
Size	B6
Looking techniques	Single locking lever
<b>Environmental characteristics   Climatic</b>	
Operating temperature min.	-40 °C
Operating temperature max.	100 °C
Climatic category (EN IEC 60068-1)	40/100/21