

**B10 Surface mounted h., high profile, IP65**

Double locking lever m., side entry M25

B10

Surface mounted housing (high)

Double locking lever

IP65

Technical data will be only guaranteed with Murrelektronik components.

**[Link to Product](#)****Illustration**

Product may differ from Image

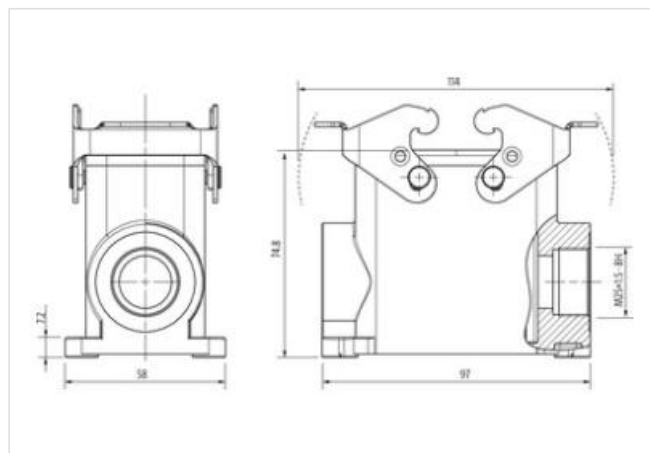
**Commercial data**

ECLASS-6.0	27143424
ECLASS-6.1	27261203
ECLASS-7.0	27440202
ECLASS-8.0	27440202
ECLASS-9.0	27440202
ECLASS-10.1	27440202
ECLASS-11.1	27440202
ECLASS-12.0	27440202
ETIM-5.0	EC000437
customs tariff number	85389099
GTIN	4048879646239
Packaging unit	1

**Installation**

Cable outlet	laterally
--------------	-----------

**Installation | Connection**

Mounting set	M25
Mating cycles min.	500

**Device protection | Electrical**

Degree of protection (EN IEC 60529)	IP65
Additional condition protection degree	inserted, locked, with screw connection

**Mechanical data**

Housing type	Surface mounted housing
--------------	-------------------------

**Mechanical data | Material data**

Coating housing	powder-coated
-----------------	---------------

Coating locking	verzinkt
-----------------	----------

Material gasket	NBR
-----------------	-----

Material housing	Aluminum die casting
------------------	----------------------

Locking material	Steel
------------------	-------

**Mechanical data | Mounting data**

Size	B10
------	-----

Height	74,8 mm
--------	---------

Width	58 mm
-------	-------

Depth	97 mm
-------	-------

Locking techniques	Double locking lever
--------------------	----------------------

**Environmental characteristics | Climatic**

Operating temperature min.	-40 °C
----------------------------	--------

Operating temperature max.	100 °C
----------------------------	--------

Climatic category (EN IEC 60068-1)	40/100/21
------------------------------------	-----------