

B10 Surface mounted h., low profile, IP65

Double locking lever m., side entry M25

B10

Surface mounted housing (low)

Double locking lever

IP65

Technical data will be only guaranteed with Murrelektronik components.

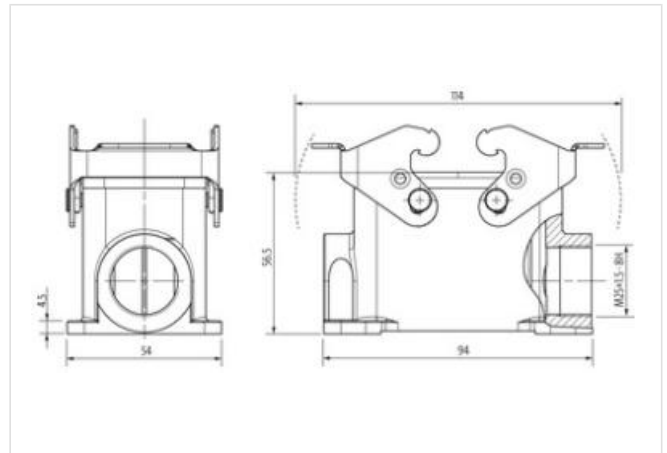
[Link to Product](#)**Illustration**

Product may differ from Image

Commercial data

ECLASS-6.0	27143424
ECLASS-6.1	27261203
ECLASS-7.0	27440202
ECLASS-8.0	27440202
ECLASS-9.0	27440202
ECLASS-10.1	27440202
ECLASS-11.1	27440202
ECLASS-12.0	27440202
ETIM-5.0	EC000437
customs tariff number	85389099
GTIN	4048879646222
Packaging unit	1

Installation

Cable outlet	laterally
--------------	-----------

Installation | Connection

Mounting set	M25
Mating cycles min.	500

Device protection | Electrical

Degree of protection (EN IEC 60529)	IP65
Additional condition protection degree	inserted, locked, with screw connection

Mechanical data

Housing type	Surface mounted housing
--------------	-------------------------

Mechanical data | Material data

Coating housing	powder-coated
-----------------	---------------

Coating locking	verzinkt
-----------------	----------

Material gasket	NBR
-----------------	-----

Material housing	Aluminum die casting
------------------	----------------------

Locking material	Steel
------------------	-------

Mechanical data | Mounting data

Size	B10
------	-----

Height	56,5 mm
--------	---------

Width	54 mm
-------	-------

Depth	94 mm
-------	-------

Locking techniques	Double locking lever
--------------------	----------------------

Environmental characteristics | Climatic

Operating temperature min.	-40 °C
----------------------------	--------

Operating temperature max.	100 °C
----------------------------	--------

Climatic category (EN IEC 60068-1)	40/100/21
------------------------------------	-----------