

## B10 Hood, high profile, IP65

Single locking lever, top entry M32

B10

Hood (high)

Single locking lever

IP65

Technical data will be only guaranteed with Murrelektronik components.

### [Link to Product](#)

#### Illustration



Product may differ from Image

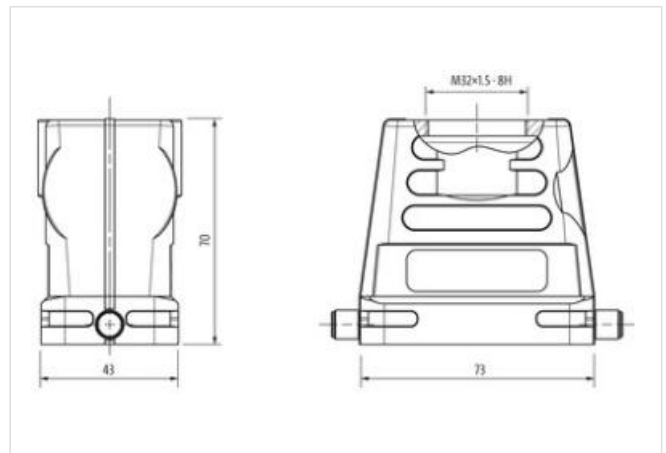

#### Commercial data

ECLASS-6.0	27143424
ECLASS-6.1	27261203
ECLASS-7.0	27440202
ECLASS-8.0	27440202
ECLASS-9.0	27440202
ECLASS-10.1	27440202
ECLASS-11.1	27440202
ECLASS-12.0	27440202
ETIM-5.0	EC000437
customs tariff number	85389099
GTIN	4048879646413
Packaging unit	1

#### Installation

Cable outlet	straight
--------------	----------

#### Installation | Connection

Mounting set	M32
Mating cycles min.	500

#### Device protection | Electrical

Degree of protection (EN IEC 60529)	IP65
Additional condition protection degree	inserted, locked, with screw connection

#### Mechanical data

Housing type	Hood
--------------	------

#### Mechanical data | Material data

Coating housing	powder-coated
-----------------	---------------

Coating locking	verzinkt
-----------------	----------

Material housing	Aluminum die casting
------------------	----------------------

Locking material	Steel
------------------	-------

**Mechanical data | Mounting data**

Size	B10
------	-----

Height	70 mm
--------	-------

Width	43 mm
-------	-------

Depth	73 mm
-------	-------

Locking techniques	Single locking lever
--------------------	----------------------

**Environmental characteristics | Climatic**

Operating temperature min.	-40 °C
----------------------------	--------

Operating temperature max.	100 °C
----------------------------	--------

Climatic category (EN IEC 60068-1)	40/100/21
------------------------------------	-----------