

B10 Hood, high profile, IP65

Double locking lever, side entry M25

B10
Hood (high)
Double locking lever
IP65
Technical data will be only guaranteed with Murrelektronik components.

Link to Product

Illustration



Product may differ from Image

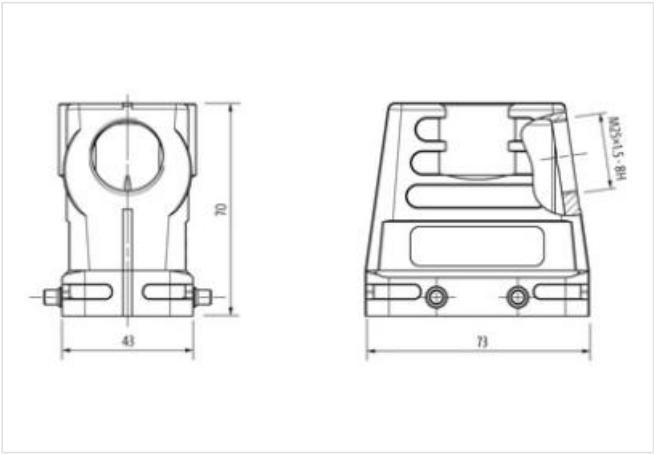

Commercial data

| | |
|-----------------------|---------------|
| ECLASS-6.0 | 27143424 |
| ECLASS-7.0 | 27440209 |
| ECLASS-8.0 | 27440209 |
| ECLASS-9.0 | 27440209 |
| ECLASS-10.1 | 27440202 |
| ECLASS-11.1 | 27440202 |
| ECLASS-12.0 | 27440202 |
| ETIM-5.0 | EC000437 |
| customs tariff number | 85389099 |
| GTIN | 4048879646369 |
| Packaging unit | 1 |

Installation

Cable outlet laterally

Installation | Connection

| | |
|--------------------|-----|
| Mounting set | M25 |
| Mating cycles min. | 500 |

Device protection | Electrical

| | |
|----------------------------------------|-----------------------------------------|
| Degree of protection (EN IEC 60529) | IP65 |
| Additional condition protection degree | inserted, locked, with screw connection |

Mechanical data

Housing type Hood

Mechanical data | Material data

Coating housing powder-coated

| | |
|------------------|----------------------|
| Coating locking | verzinkt |
| Material housing | Aluminum die casting |
| Locking material | Steel |

Mechanical data | Mounting data

| | |
|--------------------|----------------------|
| Size | B10 |
| Height | 70 mm |
| Width | 43 mm |
| Depth | 73 mm |
| Locking techniques | Double locking lever |

Environmental characteristics | Climatic

| | |
|------------------------------------|-----------|
| Operating temperature min. | -40 °C |
| Operating temperature max. | 100 °C |
| Climatic category (EN IEC 60068-1) | 40/100/21 |