

### Double locking lever, top entry M32

B24  
Hood (high)  
Double locking lever  
Cable outlet straight  
IP65

Technical data will be only guaranteed with Murrelektronik components.

**Link to Product**

### Illustration



Product may differ from Image

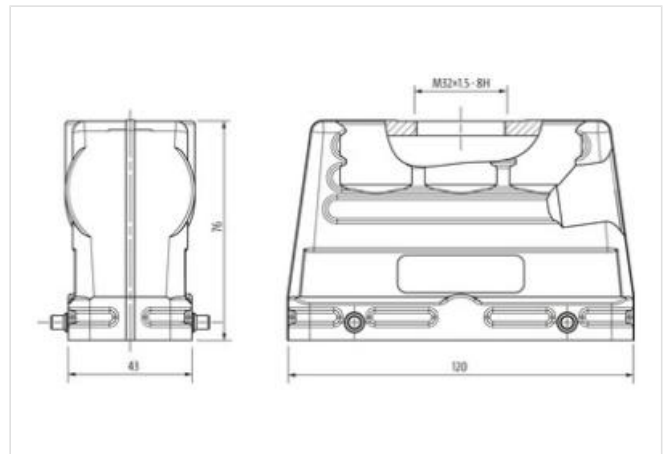

## Commercial data

ECLASS-6.0	27143424
ECLASS-6.1	27261203
ECLASS-7.0	27440202
ECLASS-8.0	27440202
ECLASS-9.0	27440202
ECLASS-10.1	27440202
ECLASS-11.1	27440202
ECLASS-12.0	27440202
ETIM-5.0	EC000437
customs tariff number	85389099
GTIN	4048879647052
Packaging unit	1

## Installation

Cable outlet	straight
--------------	----------

## Installation | Connection

Mounting set	M32
Mating cycles min.	500

## Device protection | Electrical

Degree of protection (EN IEC 60529)	IP65
Additional condition protection degree	inserted, locked, with screw connection

### Mechanical data

Housing type	Hood
Public housing	100%
Private housing	100%
Homeless	100%
Other	100%

Mechanical data   Material data	
Coating housing	powder-coated
Coating locking	verzinkt
Material housing	Aluminum die casting
Locking material	Steel
Mechanical data   Mounting data	
Size	B24
Height	76 mm
Width	43 mm
Depth	120 mm
Locking techniques	Double locking lever
Environmental characteristics   Climatic	
Operating temperature min.	-40 °C
Operating temperature max.	100 °C
Climatic category (EN IEC 60068-1)	40/100/21